



CHARLES GREY



Quality. Experience. Service.



Charles Grey has experienced generous support within the marketplace through our trusted partners and friends. We are proud to announce an extension of the full service platform that Charles Grey has developed and continue with moving the brand forward by now offering Nori Mills Stair Systems, Vista Aluminum Railing, Jamsil Guard, Eva-Last Composite Decking.

Familiar and friendly faces that keep customers and employees first.

Charles Grey proudly serves the Carolinas and beyond. A name synonymous with quality and service, we bring you over twenty-five years of experience in the millwork industry. Knowledge, combined with experience, powers Charles Grey to understand what our LBM partners need and more importantly, when they need it. With strategic locations, we offer the ability of next-day delivery for most customers. We are committed to service our building partners as the leading wholesale distributors of mouldings, boards, and stair systems.

QUALITY
EXPERIENCE
SERVICE



TABLE OF CONTENTS

Charles Grey Mouldings

2-3	Crown Mouldings
4-5	Cove Mouldings
6-7	Door + Window Trim
8-9	Trim
11	Base Cap/Quarter Round/Shoe Moulding
12-13	Base Mouldings
14	Window Stool
15	Door Components
16	Miscellaneous
17	Eased Edge Profiles

Nori Mills Stair Systems

28-30	Box Newels
31	Wood Balusters
32-35	Iron Stair Parts
36-37	Handrail
38-41	Treads
42-43	Accessories
44	Cable Options
45-47	Vista Aluminum Railings
48-55	Evalast
56	Boards
57	Index

18-19 **Jamisill Guard**

20-25 **Boards**

Radiata
MDF
Primed
PVC
Shiplap
Southern Yellow Pine
White Oak
Red Oak
Eased Edge
Spruce

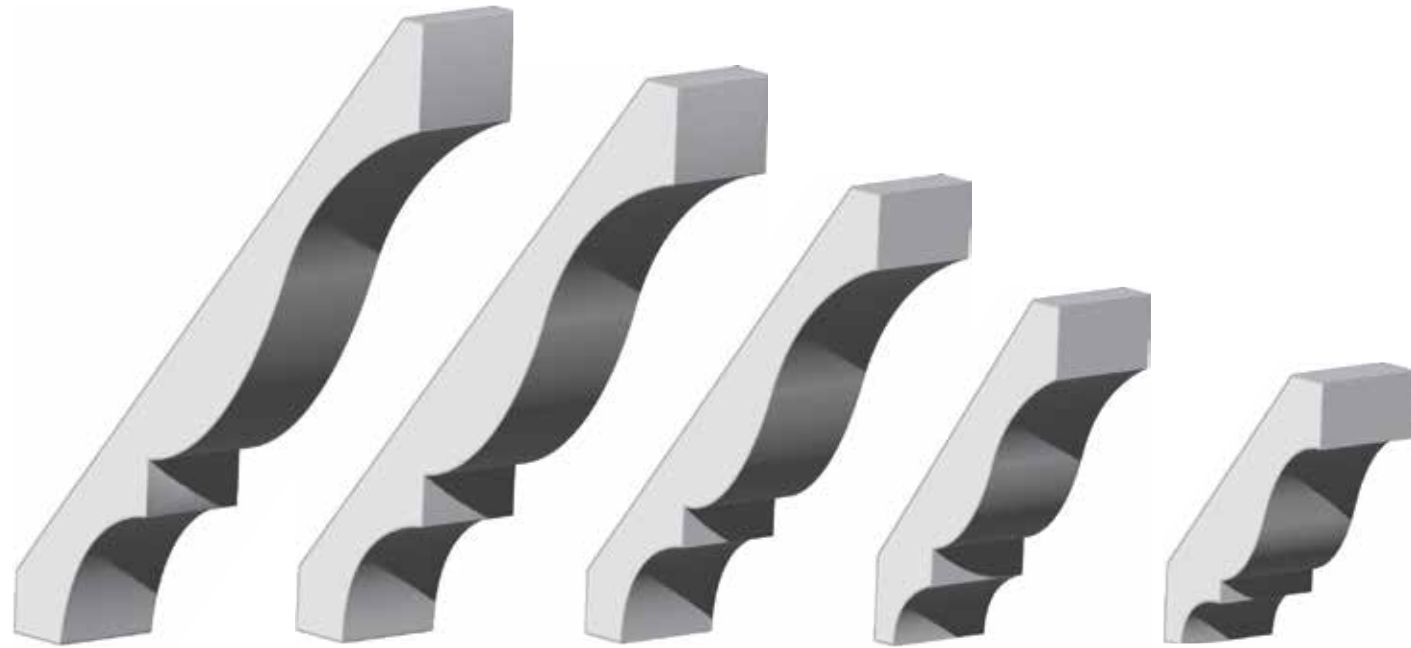

PROJECTIONS

- CG 36** 5-5/16" x 5-1/4"
- CG 37** 3-9/16" x 3-5/8"
- CG 75** 1-1/16" x 1-1/4"



CG 41	CG 45	CG 47	CG 49	CG 52
17 MM x 7" PRM MDF	9/16 x 5-1/4" PRM FJ 9/16 x 5-1/4" Raw FJ 9/16 x 5-1/4" PVC 14 MM x 5-1/4" PRM MDF	9/16 x 4-5/8" PRM FJ 9/16 x 4-5/8" Raw FJ 9/16 x 4-5/8" Solid Pine 12MM x 4-5/8" PRM MDF 14MM x 4-5/8" PRM MDF	9/16 x 3-5/8" PRM FJ 9/16 x 3-5/8" Raw FJ 9/16 x 3-5/8" Solid Pine 12MM x 4-5/8" PRM MDF	9/16 x 2-3/4" PRM FJ 9/16 x 2-3/4" Raw FJ 9/16 x 2-3/4" Solid Pine 9/16 x 2-3/4" PVC

PROJECTIONS

- CG 41** 4-5/16" x 5-1/2"
- CG 45** 3-3/8" x 4-1/16"
- CG 47** 2-7/8" x 3-5/8"
- CG 49** 2" x 3"
- CG 52** 1-5/8" x 2-1/4"



Crown Mouldings

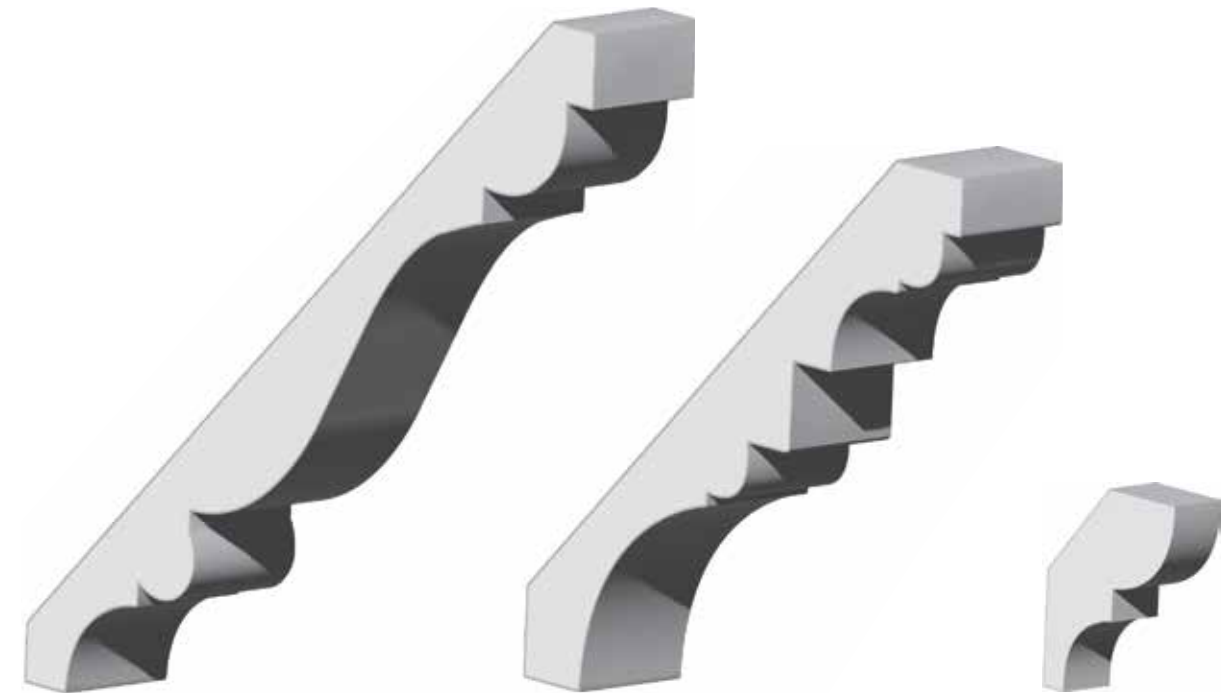

CG 36
18 MM x 7-1/2" PRM MDF

CG 37
11/16 x 5-1/16" PRM FJ
11/16 x 5-1/16" PRM MDF

CG 75
9/16 x 1-5/8" PRM FJ
9/16 x 1-5/8" PVC



CG 33
28 MM x 6-1/4" PRM MDF



CG 40
9/16 x 4-1/4" PRM FJ



CG 50
11/16 x 5-1/4" PRM FJ
11/16 x 5-1/4" PRM MDF



CG 80
19 MM x 5-1/4" PRM MDF



CG 81
19 MM x 7" PRM MDF



CG 84
9/16 x 2-1/4" Solid Pine



CG 85
9/16 x 1-3/4" Solid Pine

PROJECTIONS	
CG 80	3-7/8" x 3-9/16"
CG 81	5-9/16" x 4-1/4"
CG 84	1-9/16" x 1-9/16"
CG 85	1-1/4" x 1-1/4"



CG 94
1 x 1-1/4" Solid Pine



CG 100
11/16 x 11/16" PRM FJ
11/16 x 11/16" Solid Pine
3/4 x 3/4" PVC
5/8 x 5/8" Red Oak

PROJECTIONS	
CG 33	4-7/16" x 4-7/16"
CG 40	2-3/4" x 3-3/16"
CG 50	3-11/16" x 3-11/16"
CG 94	11/16" x 1-1/8"
CG 100	11/16" x 11/16"



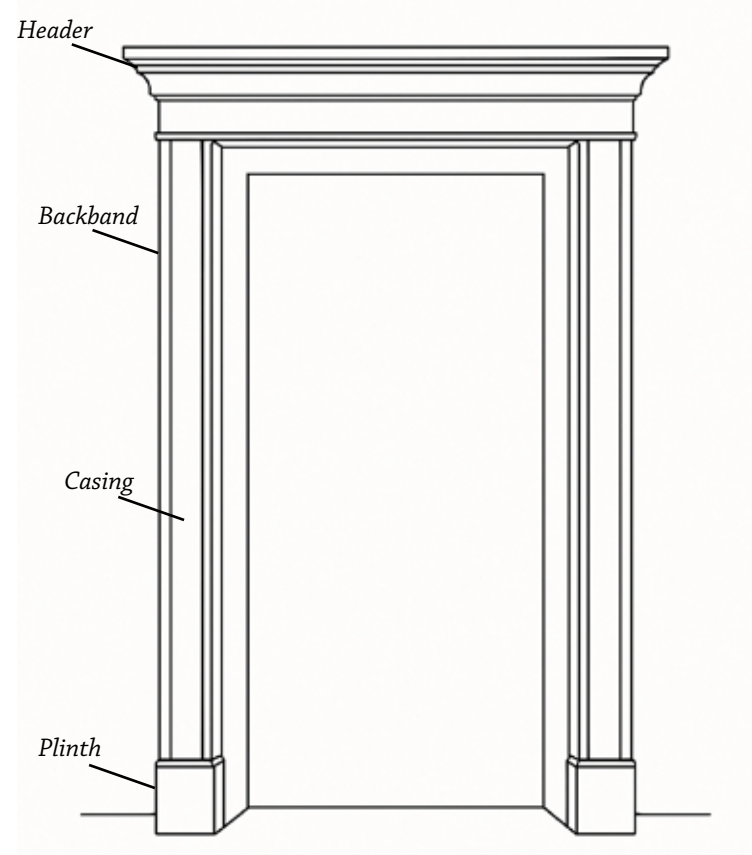

CG 280
11/16 x 1-1/16" Solid Pine



CG 281
11/16 x 1-1/16" PRM FJ
11/16 x 1-1/16" Solid Pine



CG 180
1-1/4 x 2" PRM FJ
1-1/4 x 2" PVC



CG 444
11/16 x 3-1/4" PRM FJ
11/16 x 3-1/4" Raw FJ
15MM x 3-1/4" PRM MDF



CG 445
11/16 x 3-1/4" PRM FJ
11/16 x 3-1/4" Raw FJ
11/16 x 3-1/4" Solid Pine
15MM x 3-1/4" PRM MDF

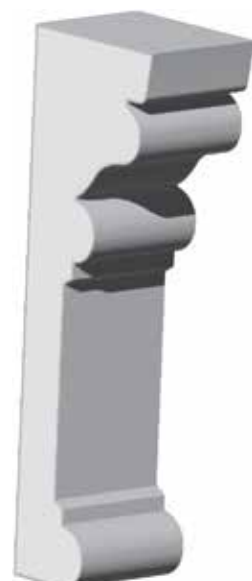

CG RB3
1-1/16 x 3-1/2" PRM FJ
1-1/16 x 3-1/2" Raw FJ
1-1/16 x 3-1/2" PVC
25MM x 3-1/2" PRM MDF



CG 327
11/16 x 2-1/4" PRM FJ



CG 356
11/16 x 2-1/4" PRM FJ
11/16 x 2-1/4" Raw FJ
11/16 x 2-1/4" Solid Pine
11/16 x 2-1/4" PVC
11/16 x 2-1/4" PRM MDF



CG 376
11/16 x 2-1/4" PRM FJ



CG 442
11/16 x 2-1/4" PRM FJ



CG 366
11/16 x 2-1/4" PRM FJ



CG 20
1-1/16 x 3-1/2" PRM FJ



CG 460
1-1/16 x 3-11/16" PRM FJ
1-1/16 x 3-11/16" Raw FJ
25MM x 3-11/16" PRM MDF



CG 470
1-1/16 x 3-11/16" PRM FJ
1-1/16 x 3-11/16" Raw FJ



CG 935
3/8 x 1-5/8" Solid Pine



CG 937
3/8 x 1-1/4" Solid Pine



CG 940
7/16 x 7/8" Solid Pine



CG 941
7/16 x 5/8" Solid Pine



CG 941-A
7/16 x 3/4" Solid Pine

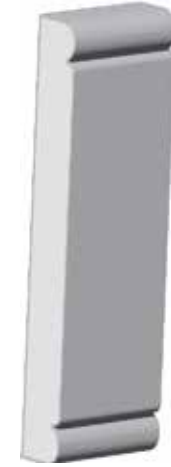

CG 425
1/2 x 4-1/2" PRM FJ



CG 398
1/2 x 5-1/4" PRM FJ
1/2 x 5-1/4" PRM MDF



CG 205
1-1/8 x 1-1/8" Solid Pine
1-1/8 x 1-1/8" PVC



CG 206
3/4 x 3/4" Solid Pine



CG 142
1/4 x 3/4" Solid Pine



CG 266
1/4" x 1-1/2" Solid Pine
1/4" x 1-1/2" PVC

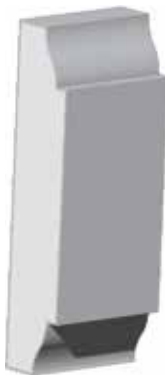

CG 987
3/8 x 2" Solid Pine



CG 988
3/8 x 1-1/2" Solid Pine



CG 988A
3/8 x 1-5/16" Solid Pine



CG 989
3/8 x 1-1/8" Solid Pine



CG 300
1-1/16 x 3" PRM FJ



CG 289
1-1/16 x 1-9/16" PRM FJ



CG 390
11/16 x 2-5/8" PRM FJ



CG 397
1 x 3-1/2" PRM FJ
1 x 3-1/2" PRM MDF



CG 394-A
1-1/8 x 2-5/8" Raw FJ



CG 133
11/16 x 1-3/4" PRM FJ
11/16 x 1-3/4" Solid Pine



CG 135
5/8 x 1-3/16" PRM FJ



CG 183
9/16 x 1-1/8" Solid Pine



BASE CAP / QUARTER ROUND / SHOE MOULDING



CG 163
 11/16 x 1-3/8" PRM FJ
 11/16 x 1-3/8" Solid Pine



CG 164
 11/16 x 1-1/8" PVC



CG 166
 11/16 x 1-1/4" Solid Pine



CG 42 - Rabbet
 1-1/16" x 1-5/8"
 PRM FJ Pine RAB



CG 106
 11/16 x 11/16" Red Oak
 11/16 x 11/16" PRM FJ
 11/16 x 11/16" PRM LVL
 11/16 x 11/16" Solid Pine
 3/4 x 3/4" PVC



CG 103
 1-1/16 x 1-1/16" Solid Pine



CG 126
 1/2 x 3/4" PRM FJ
 1/2 x 3/4" PRM LVL
 1/2 x 3/4" Solid Pine
 1/2 x 3/4" Red Oak
 1/2 x 3/4" White Oak



CG 127
 7/16 x 11/16" PRM FJ
 7/16 x 11/16" Solid Pine
 5/16 x 9/16" PVC



CG 254
 1/2 x 3/4" PRM FJ
 1/2 x 3/4" Solid Pine

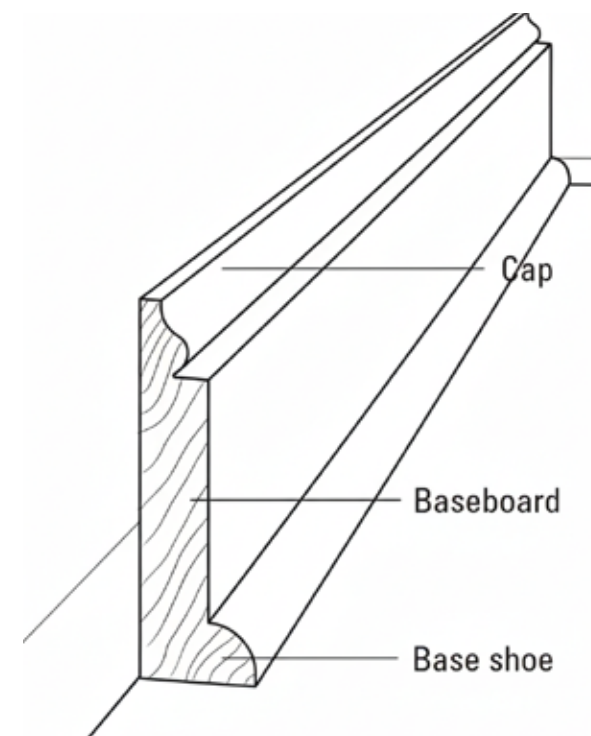

CG 42
 1-1/16 x 1-5/8" PRM FJ

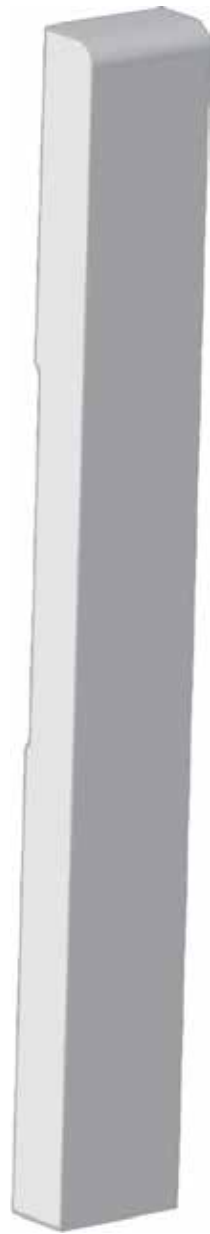

CG 714 EE
14 MM x 7-1/4" PRM MDF



CG 713
9/16 x 3-1/4" PRM FJ Pine

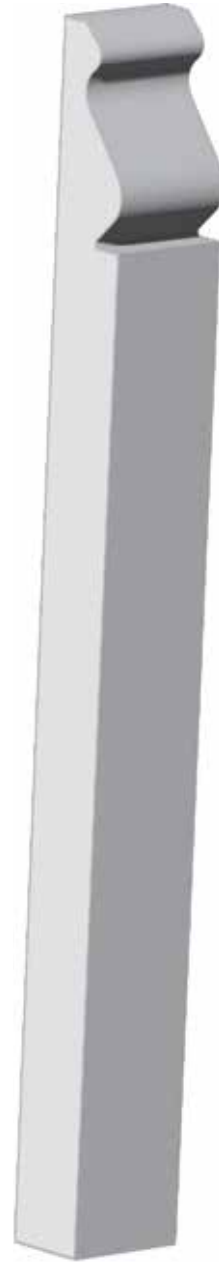

CG 810
9/16 x 7-1/4" PRM FJ
9/16 x 7-1/4" Raw FJ
12MM x 7-1/4" PRM MDF
14MM x 7-1/4" PRM MDF

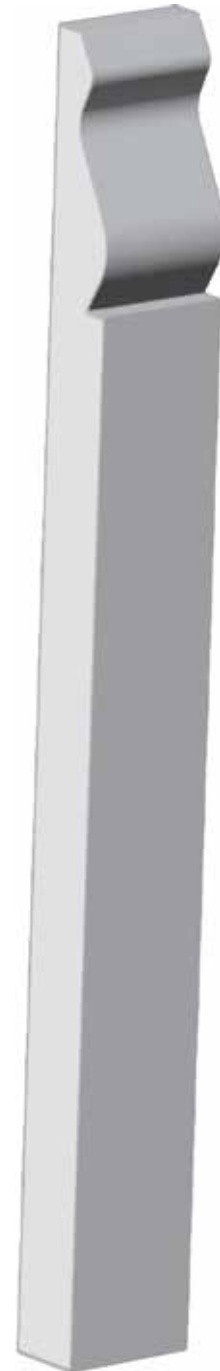

CG 910
14 MM x 9-1/4" PRM MDF

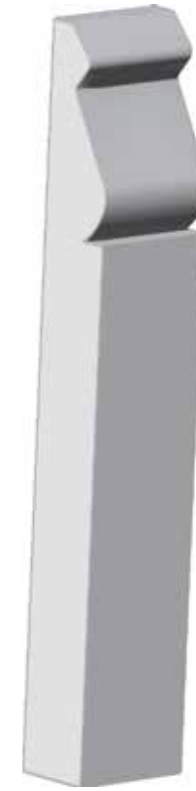

CG 610
9/16 x 5-1/4" PRM FJ
9/16 x 5-1/4" Raw FJ
12MM x 5-1/4" PRM MDF
14MM x 5-1/4" PRM MDF



CG 616
11/16 x 6-1/8" PRM FJ

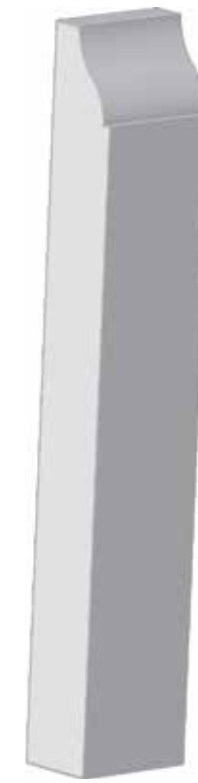

CG 618
9/16 x 5-1/4" PRM FJ
12MM x 5-1/4" PRM MDF



CG 620
9/16 x 4-1/4" PRM FJ
9/16 x 4-1/4" Raw FJ
9/16 x 4-1/4" Solid Pine
12MM x 4-1/4" PRM MDF

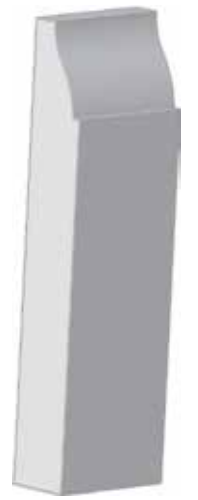

CG 623
9/16 x 3-1/4" PRM FJ
9/16 x 3-1/4" Raw FJ
9/16 x 3-1/4" Solid Pine
11/16 x 3-1/4" PVC
12MM x 3-1/4" PRM MDF

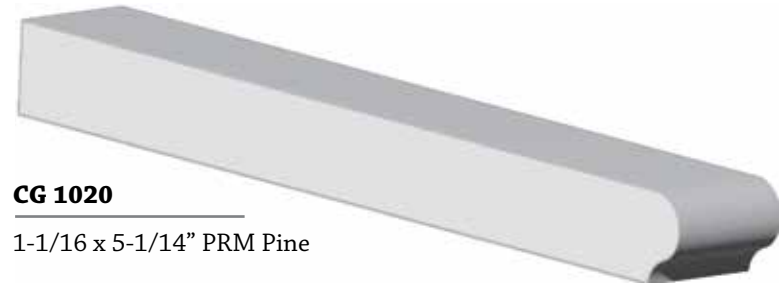

CG 1020
1-1/16 x 5-1/14" PRM Pine



CG 1021 - 11-16"
11/16 x 5-1/4" PRM FJ Pine
11/16 x 7-1/4" PRM FJ Pine
11/16 x 5-1/4" Raw FJ Pine
11/16 x 7-1/4" Raw FJ Pine
15MM x 5-1/4" PRM MDF



CG 1164
1-1/16 x 2-3/4" PRM FJ



CG 1162
1-1/6 x 3-1/4" PRM Pine



CG 1195
11/16 x 2-1/2" PRM FJ Pine RAB



CG 356
11/16" x 2-1/4" Raw FJ Pine



CG 376
11/16 x 2-1/4" PRM FJ Pine



CG 444
11/16 x 3-1/4" Raw FJ Pine



CG 445
11/16 x 3-1/4" Raw FJ Pine

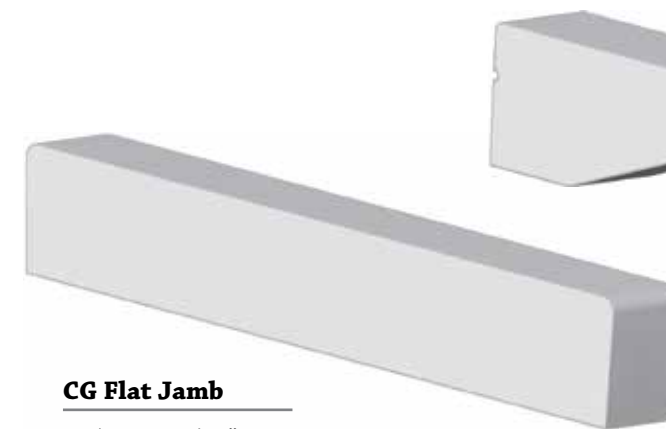

CG Flat Jamb
11/16 x 4-9/16" PRM FJ
11/16 x 4-9/16" Raw FJ
11/16 x 6-9/16" Raw FJ



CG Split Jamb
2-3/4 x 6'8" PRM Pine



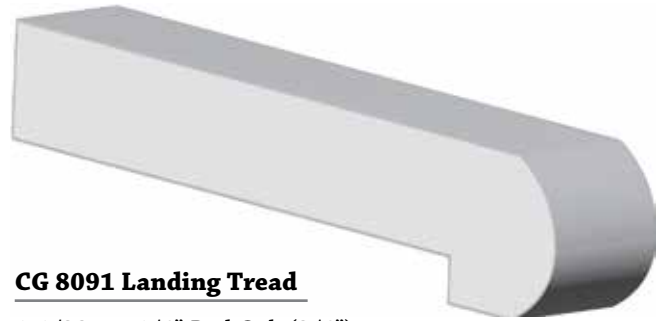

CG 8091 Landing Tread
 1-1/32 x 5-1/4" Red Oak (3/4")
 1-1/32 x 5-1/4" White Oak (3/4")



CG 8080 Stair Nosing
 1-1/16 x 1-1/4" Red Oak
 1-1/16 x 1-1/4" Yellow Pine



CG 8091 3-8 Landing Tread
 1-1/32 x 5-1/4" Red Oak (3/8")
 1-1/32 x 5-1/4" White Oak (3/8")



CG 233 Closet Rod
 1-1/4 x 1-1/4" Solid Pine
 1-1/4 x 1-1/4" LVL



CG 210 Shingle
 11/16 x 1-5/8" PRM FJ
 11/16 x 1-5/8" PVC



CG 240 Handrail
 1-1/4 x 2-1/4" Solid Pine



CG 8090
 1-1/32 x 3-1/4" Red Oak (3/4")



CG 472
 9/16" x 2-1/2" Primed



CG 452
 11/16" x 2-1/2" Primed



CG 452E
 11/16" x 2-1/2" Primed



CG 432
 9/16" x 3-1/2" Primed



CG 432E
 9/16" x 3-1/2" Primed



CG 412
 11/16" x 3-1/2" Primed



CG 412E
 11/16" x 3-1/2" Primed



CG 430
 9/16" x 4-1/4" Primed



CG 432512E
 9/16" x 5-1/2" Primed
 9/16" x 5-1/2" MDF

Jamsill Guard[®]
The ORIGINAL Sill Pan Flashing Since 1983

DOOR and WINDOW SILL PAN FLASHING

See Jammin' Jimmy and Buff in our New Technical videos at jamsill.com

"I use Jamsill Guard sill pan flashing on all my door and window installations."
- Jammin' Jimmy



Jamsill Guard[®]
The ORIGINAL Sill Pan Flashing Since 1983

Most leaks originate at...

The Critical Corner



- Reduce call-backs due to water damage
- Quick, simple and adjustable installation
- Sloped weep areas direct moisture out
- Glue joints located away from door and window leak areas
- Multiple-piece design and large glue tabs allow adjustability during install
- Accommodates virtually any size opening
- Available in many depths to fit any application
- Visit jamsill.com for more information

Sizes Stocked by Charles Grey

Single Packs				
Product	Jamb Depth	RO Range	Qty Per Case	CG ITEM #
JAMSILL SINGLE 4-9/16-3/0 (6)	4-9/16"	40" or less	6	JS-4916SP-30-SGL
JAMSILL SINGLE 4-9/16-6/0 (6)	4-9/16"	78" or less	6	JS-4916SP-60-SGL
JAMSILL SINGLE 4-9/16-9/0 (6)	4-9/16"	110" or less	6	JS-4916SP-90-SGL
JAMSILL SINGLE 6-9/16-3/0 (6)	6-9/16"	40" or less	6	JS-6916SP-30-SGL
JAMSILL SINGLE 6-9/16-6/0 (6)	6-9/16"	78" or less	6	JS-6916SP-60-SGL
JAMSILL SINGLE 6-9/16-9/0 (6)	6-9/16"	110" or less	6	JS-6916SP-90-SGL
Bulk Packs				
Product	Jamb Depth	RO Range	Qty Per Case	CG ITEM #
JAMSILL BULK 3-1/4 -6/0 (12)	3-1/4"	78" or less	12	JSB-314-60-BULK
JAMSILL BULK 3-5/8 -6/0 (12)	3-5/8"	78" or less	12	JSB-358-60-BULK
JAMSILL BULK 4-9/16-3/0 (12)	4-9/16"	40" or less	12	JSB-4916-30-BULK
JAMSILL BULK 4-9/16-6/0 (12)	4-9/16"	78" or less	12	JSB-4916-60-BULK
JAMSILL BULK 4-9/16-9/0 (12)	4-9/16"	110" or less	12	JSB-4916-90-BULK
JAMSILL BULK 6-9/16-3/0 (12)	6-9/16"	40" or less	12	JSB-6916-30-BULK
JAMSILL BULK 6-9/16-6/0 (12)	6-9/16"	78" or less	12	JSB-6916-60-BULK
JAMSILL BULK 6-9/16-9/0 (12)	6-9/16"	110" or less	12	JSB-6916-90-BULK

SELECT RADIATA

Radiata Pine boards are a premium choice for interior trim, furniture, and cabinetry projects. Our boards are surfaced four sides (S4S) and available in C-Select grade, offering superior appearance and performance.

Features + Benefits

- S4S (Surface Four Sides) for smooth, ready to use finish
- C-Select grade ensures minimal knots and consistent grain
- Ideal for painting or staining
- Lightweight and easy to handle
- Sustainability sourced Radiata Pine

Width x Thickness (inch)	Available Lengths (feet)
1x4	8', 10', 12', 14', 16'
1x6	8', 10', 12', 14', 16'
1x8	8', 10', 12', 14', 16'
1x10	8', 10', 12', 14', 16'
1x12	8', 10', 12', 14', 16'
5/4x6	12', 16'

Note: All boards are kiln-dried and precision-milled to ensure quality and consistency.



PRIMED FJ

Features + Benefits

- Finger joined construction provides structural integrity
- Primed surface saves time during finishing
- Smooth and uniform appearance makes it ideal for trim and moulding

Size	Thickness	Length
1x2	21/32"	23/32" 16'
1x3	23/32"	23/32" 16'
1x4	21/32"	23/32" 16'/17'
1x6	21/32"	23/32" 16'
1x8	21/32"	23/32" 16'
1x10	21/32"	23/32" 16'
1x12	21/32"	23/32" 16'
5/4x4	1-1/8"	16'
5/4x6	1-1/8"	16'
5/4x8	1-1/8"	16'

Note: See full board offering on page 56.

MDF

Upgrade your building projects with our high-quality MDF (Medium Density Fiberboard) products--engineered for precision, consistency, and performance.

Why Choose MDF?

- Smooth Surface: Ideal for painting and laminating.
- Consistency Density: No knots or grainf or easy cutting and shaping.
- Eco-Friendly: Made from recycled wood fibers.
- Cost-Effective: Affordable alternative to solid wood.
- Versatile Applications: Perfect for cabinetry, molding, furniture, and interior trim.

Available Sizes & Specs

Size	Type	Length	Finish	Thickness
1x2 - 1x12	MDF	16'	Primed	17mm
1x16	MDF	16'	Raw	Standard
5/4x6	MDF	16'	Primed	1-1/4"



SOUTHERN YELLOW PINE - #2 & BETTER

Features + Benefits

- Ideal for general construction / framing / shelving / utility purposes where appearance is less critical but strength & affordability are valued

Board Size	Available Lengths
1x4	8'/10'/12'/14'/16'
1x6	8'/10'/12'/14'/16'
1x8	8'/10'/12'/14'/16'

SOUTHERN YELLOW PINE - C & BETTER S4S

Features + Benefits

- Smooth, straight-grained, and with minimal knots. This grade is ideal for finish carpentry, furniture, and interior paneling where appearance matters.

Board Size	Available Lengths
1x4	8'/10'/12'/14'/16'
1x6	8'/10'/12'/14'/16'
1x8	8'/10'/12'/14'/16'
1x10	12'/16'
1x12	12'/16'
5/4 x4	12'/16'
5/4 x6	12'/16'
5/4 x8	12'/16'

SOUTHERN YELLOW PINE - PATTERN STOCK

Features + Benefits

- Premium appearance product, ideal for paneling, ceiling and decorative walls
 - All T&G V-Groove SYP is shrink-wrapped in mini bundles to remain clean until installation

C & Better Stepping
1x 11-1/4" - 12'/16'

V-Groove T&G Edge & Center Bead (reversible)
3/4" x 5-1/2" x 8'/10'/12'/14'/16'

Note: See full board offering on page 56.

RED OAK OR WHITE OAK

Features + Benefits

- Exceptional Strength and Durability - Ideal for structural and decorative applications
 - Rich Grain and Warm Color - Enhances the aesthetic appeal of any project
 - Easy to Work With - Cuts, sands, and finishes smoothly.
 - Versatile Use - Perfect for flooring, cabinetry, furniture, and trim.



Width	Length
1x4	Random Lengths
1x6	Random Lengths
1x8	Random Lengths
1x10	Random Lengths
1x12	Random Lengths

EASED EDGE SPRUCE PREMIUM BOARDS

Features + Benefits

- High-quality Spruce Hardwood for superior strength and durability
 - #2 Eased Edge for smooth handling and clean installation
 - Waxed Ends to reduce splitting and improve moisture resistance

Board Size	Available Lengths
1x4	8'/10'/12'/14'/16'
1x6	8'/10'/12'/14'/16'
1x8	8'/10'/12'/14'/16'
1x10	8'/10'/12'/14'/16'
1x12	8'/10'/12'/14'/16'

V-Groove T&G Edge & Center Bead (reversible)	
3/4" x 5-1/2"	12'/16'
3/4" x 7-1/2"	16'

AVAILABLE PROFILES

- 100 Cove
- 106 Qtr Round
- 127 Shoe
- 164 Base Cap
- 180 Brick Mould
- 197 Drip Cap
- 210 Shingle
- 236 S4S 1-1/4"
- 266 Lattice
- Crown 45/47/49
- 75 Bed
- Sill & Sill Nosing
- Rake 287 & Rams Crown
- Shiplap/Beaded



CG T&G V-Groove

1 x 6 PRM Pine
1 x 8 PRM Pine

CG Shiplap / V-Groove

1 x 6 PRM Pine

Size	Thickness	Length
1x4	3/4"	18'
1x6	3/4"	18'
1x8	3/4"	18'
1x10	3/4"	18'
1x12	3/4"	18'
5/4x4	1-1/8"	18'
5/4x6	1-1/8"	18'
5/4x8	1-1/8"	18'

Note: See full board offering on page 56.



CG Nickel Gap

1 x 6 MDF
1 x 8 MDF



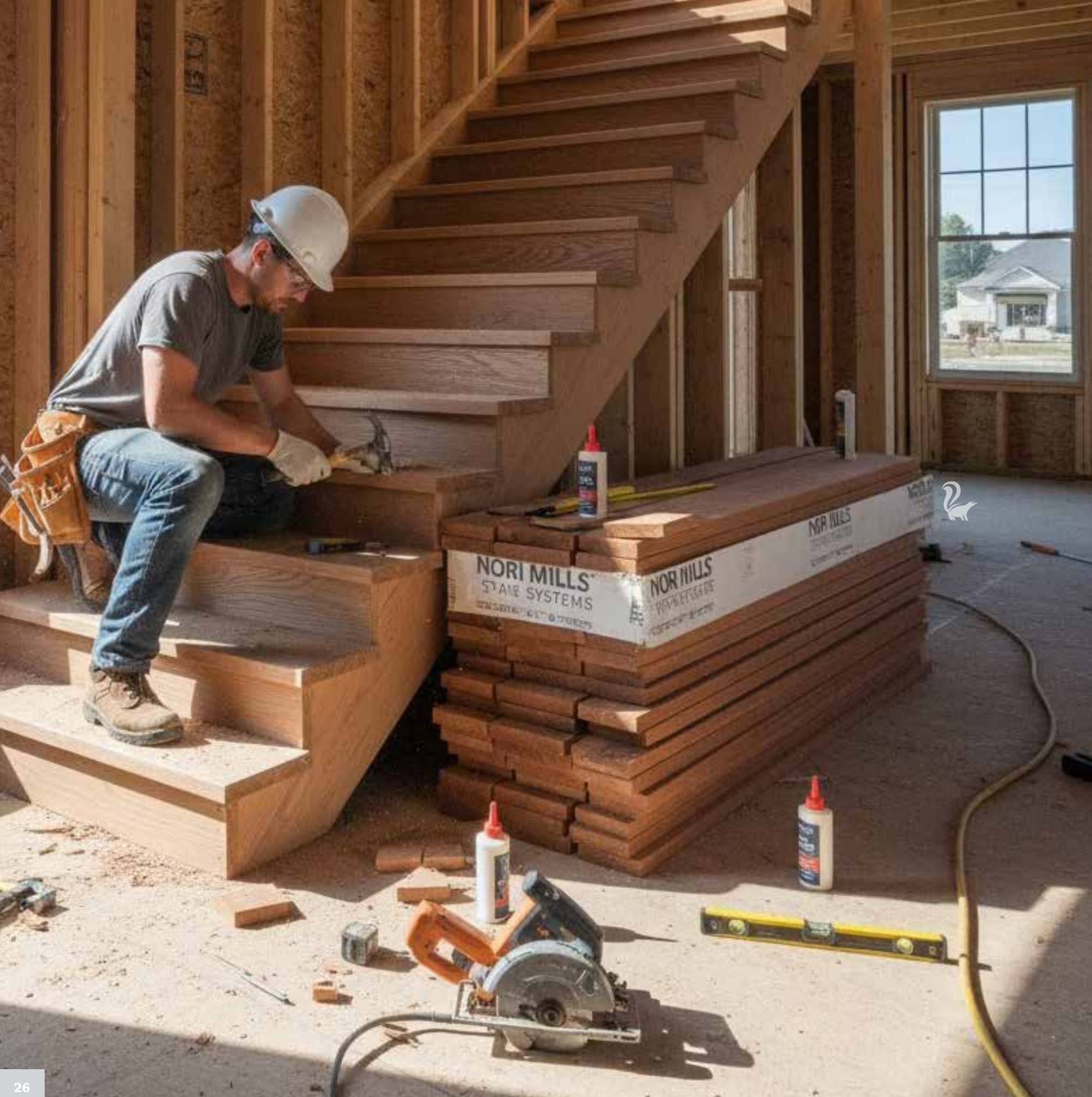

TRADITIONAL BOX NEWELS

PANEL BOX NEWELS



Newels	Red Oak	White Oak	Primed	Addl Info
4076	x	x	x	SOLID
4077	x	x		SOLID
4082	x			MB/CAP
4083	x			MB/CAP
4091	x	x	x	MB/CAP/SLV
4092	x			MB/CAP/SLV
4093	x			MB/CAP/SLV
4094			x	SOLID
4095			x	SOLID
4097	x	x		MB/CAP
4098	x	x		MB/CAP/SLV
4176	x			SLV

SLV - adjustable sleeve included
 SOLID - solid bottom for mounting
 MB - pre-drilled mounting block included
 CAP - two caps included (square top & beveled top)

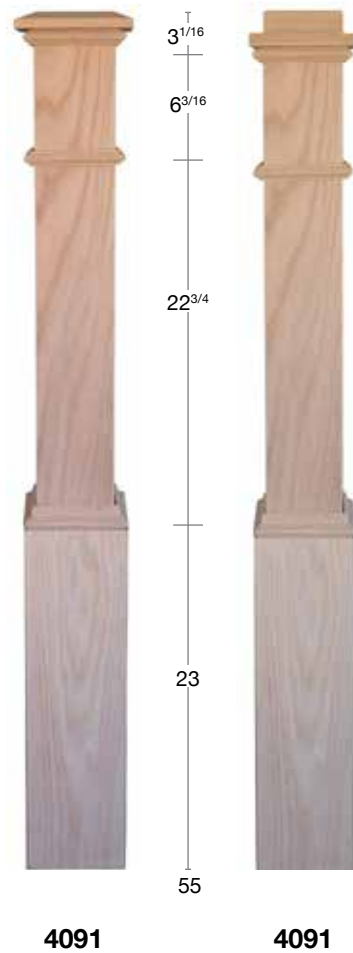

Interchangeable Newel Cap



Newels	Red Oak	White Oak	Primed	Addl Info
4076	x	x	x	SOLID
4077	x	x		SOLID
4082	x			MB/CAP
4083	x			MB/CAP
4091	x	x	x	MB/CAP/SLV
4092	x			MB/CAP/SLV
4093	x			MB/CAP/SLV
4094			x	SOLID
4095			x	SOLID
4097	x	x		MB/CAP
4098	x	x		MB/CAP/SLV
4176	x			SLV



SLV - adjustable sleeve included
 SOLID - solid bottom for mounting
 MB - pre-drilled mounting block included
 CAP - two caps included (square top & beveled top)



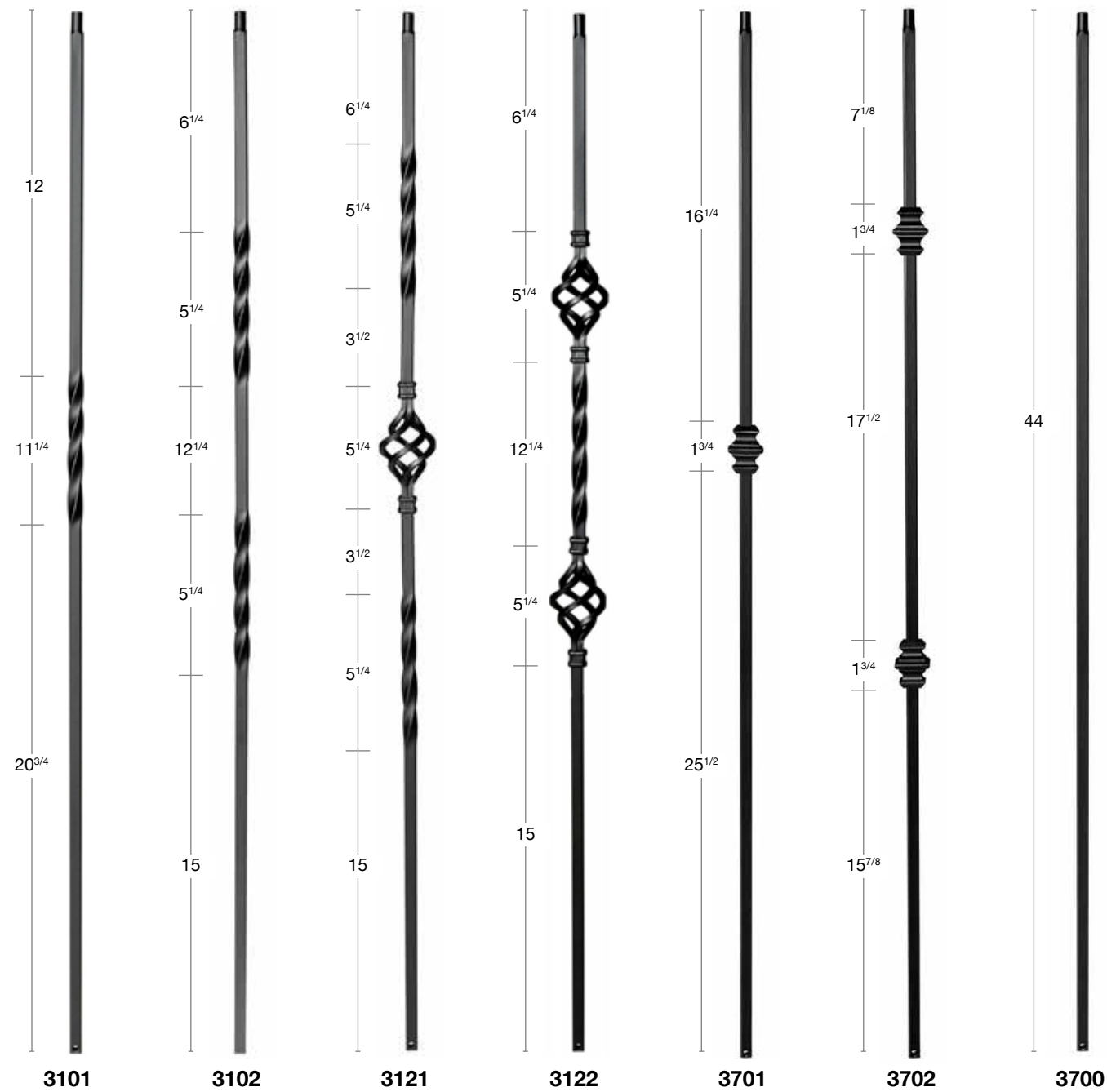

3811
Flat Base



3821
Angle Base



3831

Includes Set Screw



The Ellison Collection:

Where Modern Design Meets Timeless Elegance

Elevate your space with the refined simplicity of the Ellison Collection. Featuring metal bars in a sophisticated flat black finish, this collection is designed to offer unobstructed views while infusing your project with a bold, contemporary aesthetic. Whether you're building anew or refreshing an existing space, the Ellison Collection delivers a lasting impression of style and modernity.

9058 - Horizontal Stair Tube

96"

9068 - Vertical Tube

5/8" x 44"

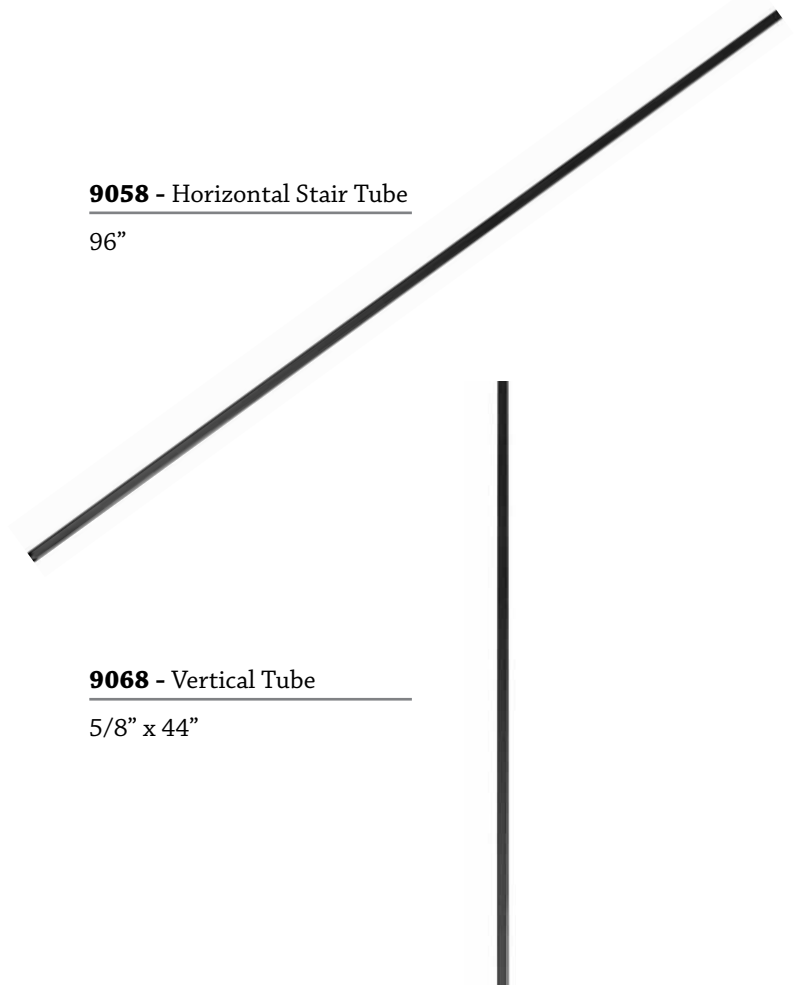

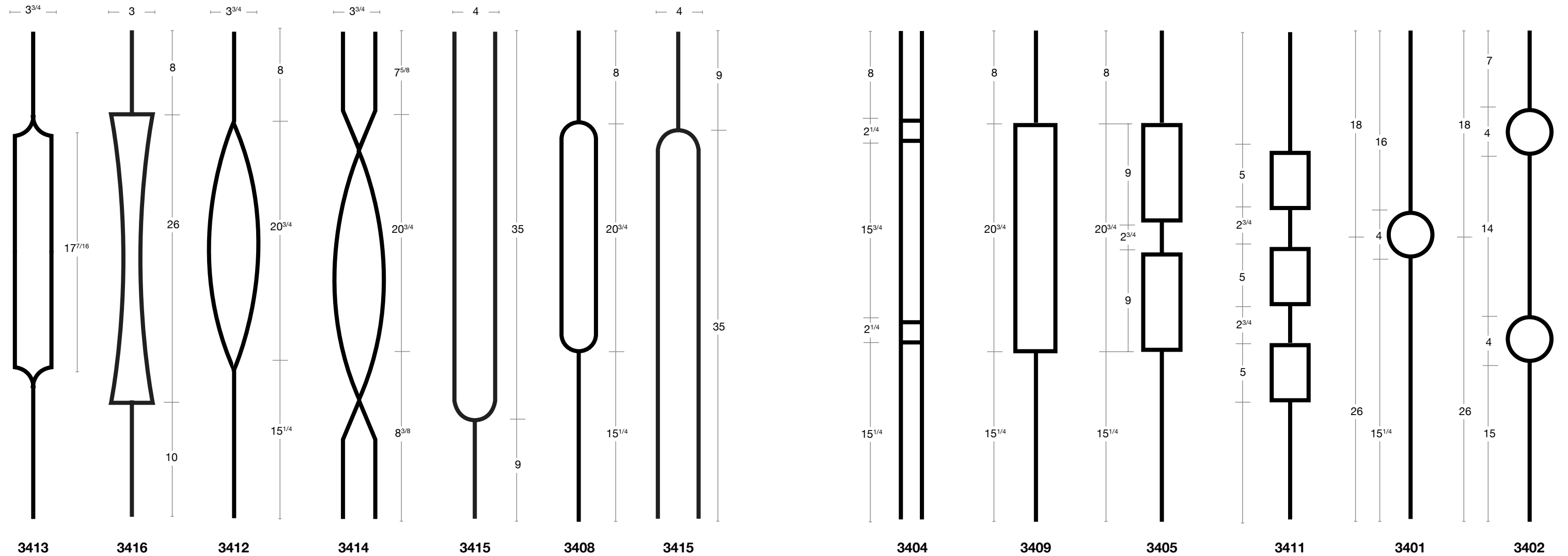

The Duncan Collection is a series of visually pleasing flat black balusters that make endless custom opportunities for your clients. Easy to handle and install, these 1/2" hollow balusters create the look of luxury without the price tag.

Combining materials like wood and metal creates a dynamic look and adds beauty to function.





6010 Plowed*



6210



6310



7019 / 7219



7012 / 7212 / 7312

HANDRAIL	Red Oak	White Oak
6000 Plowed	✓	✓
6001 Plowed	✓	✓
6002	✓	✓
6010	✓	✓
6010 Plowed	✓	✓
6040	✓	✗
6042	✓	✗
6210	✓	✓
6210 Plowed	✓	✓
6310	✓	✓
6840	✓	✓

Plowed handrail shipped with Fillet.
All handrail is shipped shrinkwrapped.



6040



6840



6000P*



6001P*



7010 / 7210



7011 / 7211 / 7311



6002



6010



6042



7021 / 7221



7099 / 7299 / 7399



* All plowed handrail is shipped with Fillet

Red Oak

Our red oak stair treads are hand selected, with color-matched solid oak staves for strength, quality and visual appeal. The unfinished natural wood grain is ready for your finish!

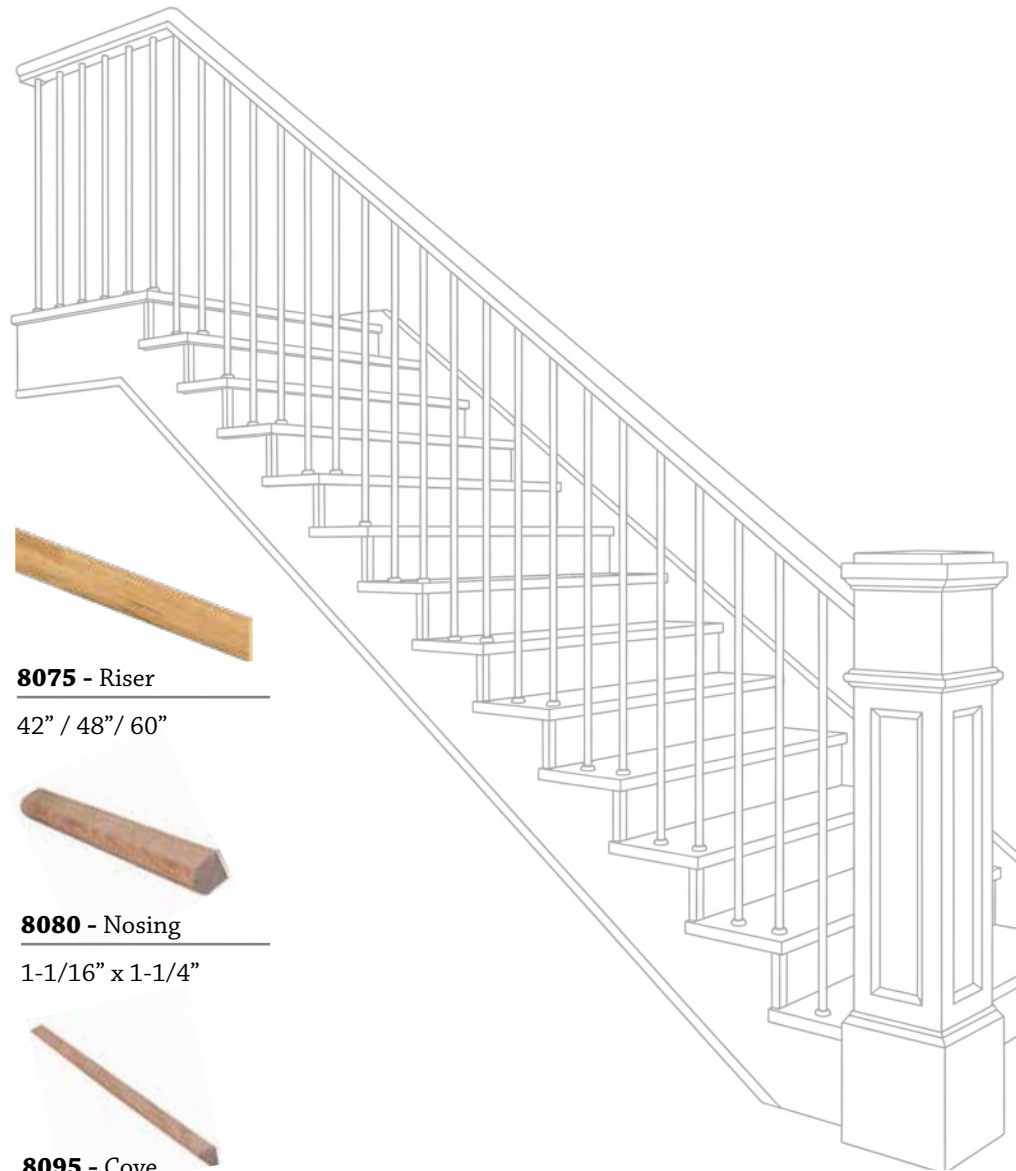

8075 - Riser

42" / 48" / 60"

8080 - Nosing

1-1/16" x 1-1/4"

8095 - Cove

1/2" x 3/4"



8070 - Plain Tread

36" / 42" / 48" / 54" / 60" / 72" / 96"



8070 - Miter Return

42" / 48" / 54" / 60" / 72"



8070 - Hybrid Mitered Return

48"



8071 - False Tread Cap LH/RH

6-5/8 x 16 LH/RH



Landing Tread

8091 - 3/8" (1-1/32" x 5-1/4")

8090 - 3/4" (1-1/32" x 3-1/4")

8090 - 3/4" (1-1/32" x 5-1/4")

8097 - 3/4" (1-1/32" x 7-1/4")



Yellow Pine

8070 - SYP

12' Step Tread (5/4" x 11-1/4")

16' Step Tread

8080 - SYP

Stair Nosing (1-1/16" x 1/4")

8091 - SYP

Landing Tread (3/4" x 5-1/4")

White Oak

Our white oak stair treads are hand selected, with color-matched solid oak staves for strength, quality and visual appeal. The unfinished natural wood grain is ready for your finish! Complete your project with white oak nosing, risers and skirt boards.



8075 - Riser

42" / 48" / 60"



8080 - Nosing

1-1/16" x 1-1/4"



8095 - Cove

1/2" x 3/4"



8070 - Plain Tread

42" / 48" / 54" / 60" / 72" / 96"



8070 - Miter Return

48" / 54" / 60"



Landing Tread

8091 - 3/4" x 5-1/4"

8097 - 3/4" x 7-1/4"

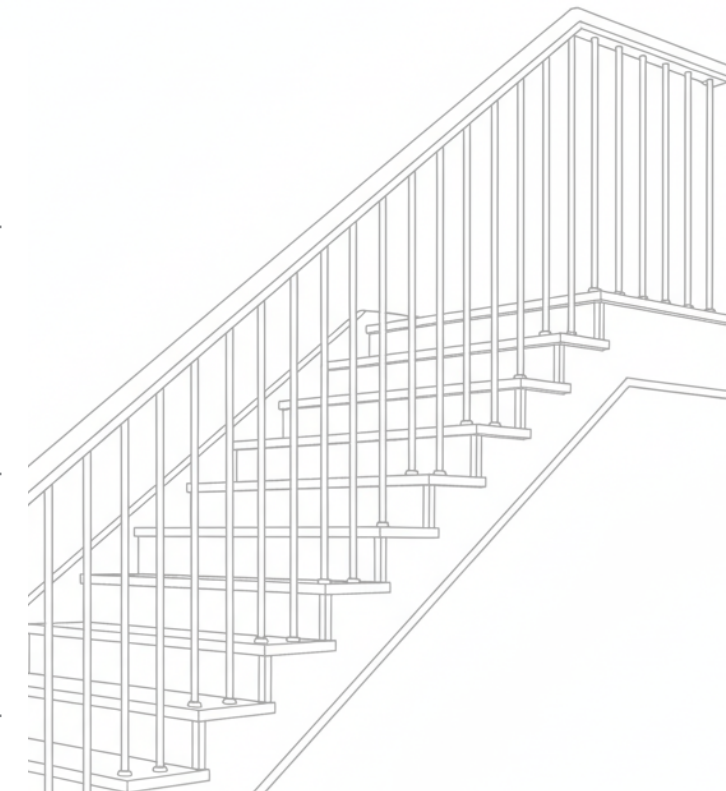

Red Oak



8070 - Square Edge Red Oak Plain
48" / 60"



8080 - Square Edge Nosing
1-1/16" x 13"



8070 - Square Edge Mitered Red Oak MR
48" / 54" / 60"



8091 SQ - Square Edge
3/4" x 5-14"

White Oak



8070 - White Oak Plain
42" / 48" / 54" / 60" / 72"



8070 - White Oak Miter Return
48" / 54" / 60"



8091 SQ - Square Edge White Oak
3/4" x 5-14"

8070 Plain

Length	Red Oak	White Oak
36"	✓	X
42"	✓	✓
48"	✓	✓
54"	✓	✓
60"	✓	✓
72"	✓	✓
96"	✓	✓

8070 Miter Returned

Length	Red Oak	White Oak
42"	✓	X
48"	✓	✓
54"	✓	✓
60"	✓	✓
72"	✓	X

8070 Square Edge

Length	Red Oak	White Oak
48" Plain	✓	✓
60" Plain	✓	✓
48" MRT	✓	✓
60" MRT	✓	✓

Landing Tread

	SIZE	Red Oak	White Oak	SYP
8090 Bullnose	1-1/32 x 3 1/4"	✓		
8091 Bullnose 3/4" Back	1-1/32 x 5 1/4"	✓	✓	✓
	1-1/32 x 7 1/4"	✓	✓	
8091 Bullnose 3/8" Back	1-1/32 x 5 1/4"	✓	✓	



8091 Square Edge

	SPEC	Red Oak	White Oak	SYP
3/4" Back	1 1/32 x 5 1/4"	✓	✓	
3/8" Back	1-1/32 x 5 1/4"		✓	

Rosettes



7027

7037

7027 Square

Wall Rail Brackets



3027

Black, Bronze, & Nickel



3038 Epoxy Gun (tips and 50ml epoxy sold separately)
3039 Epoxy refill (Includes 2 tips)
3037 Tips 2PK



3005 KeyLock Fastener



3006 Newel Mounting Plate

Bracket



3002
Bronze & Nickel

Newel Hardware



3078 Newel Post Package



3009 3" Newel Mount Kit Red Oak

3019 3-1/2" Newel Mount Kit Red Oak



3092 Rail Bolt Wrench



3008 Newel Post Fastener



3137 Epoxy Tips - 6pk



3139 250 ML Epoxy for Caulk Gun

Shoes/Knuckles



3811

3821

3831

Includes Set Screw



3076 Dowel Screw (50pk/20pk)



3004 Newel Mounting Kit



3074 Lag Screw for Newel Post Block

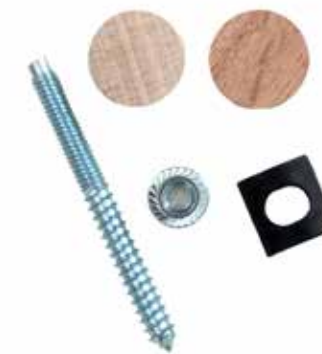

3001 Rail Bolt



3088 Dowel Driver

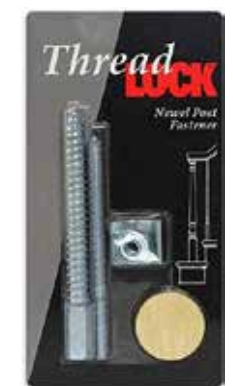

3070 Newel Post Fastener

CABLE OPTIONS

Stainless steel cable and hardware for interior and exterior applications. Nori Mills carries a full inventory of contemporary red oak and white oak components including handrails, newels, and intermediate supports to compliment any interior cable installation.

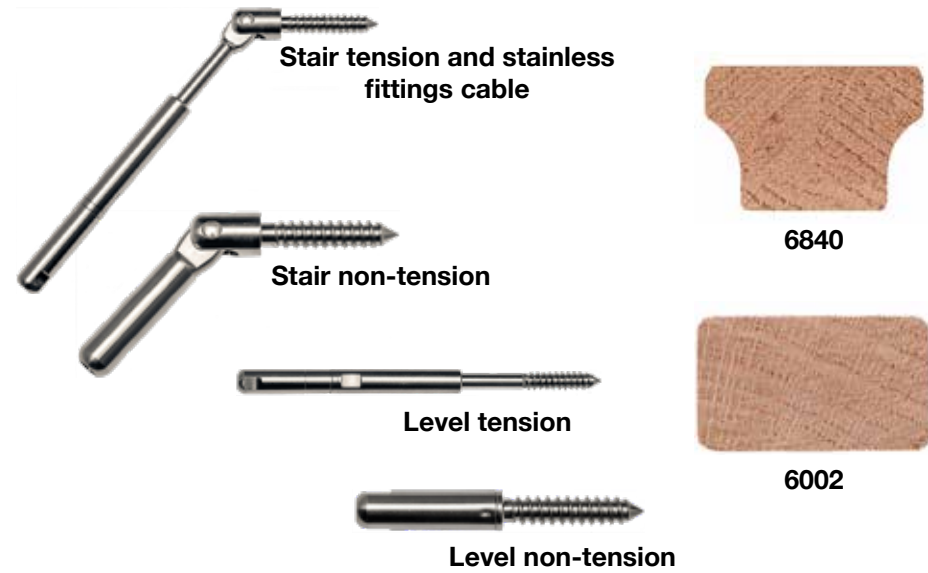

Vista Railing Systems

- Aluminum Railing Systems
- Stock Colors – Black, Bronze, & White
 - Standard Pickets
 - Wide Pickets
 - Glass
 - Cable
 - Drink Rail System

- Cable
- Fittings, Cable, and Accessories
 - Exterior or Interior







Eva-Last composite decking is designed to make any outdoor area more beautiful, hassle-free, and sustainable. With three unique ranges of low-maintenance decking available, Eva-Last composite is the ideal environmentally-friendly alternative to timber decking. Choose from an extensive range of natural colors, finishes, and accessories within each product line – all offering long-lasting durability and resilience.



THE EVA-LAST RANGE

Eva-Last offers four unique decking technologies, each with their own distinct characteristics, benefits, look, and feel. Discover which composite range is right for you.

RENEWABLE RESOURCES & RENEWABLE ENERGY

We believe that how we manufacture is just as important as what we manufacture when it comes to going green. That's why we've traded in fossil fuels for renewable energy. Our products use solar power as part of our manufacturing process. We are fully committed to bringing you a product that's holistically eco-conscious.

Every Eva-Last range pairs recycled raw ingredients with bamboo for a stronger, more sustainable composite. Bamboo rejuvenates over 30 times faster than traditional hardwoods and it releases 35% more oxygen into our air. Eva-Last is internationally recognized for our commitment to the environment. We're proud of the work we do to promote environmental



LOW ENVIRONMENTAL IMPACT
Holistically sustainable manufacturing & use of raw materials

- Made from recycled materials
- No trees felled
- No treatment or toxic chemicals required for maintenance
- Solar power used in the manufacturing process
- Reduced impact on landfills

Pioneer



RARE WOOD REPLICATED IN REINFORCED BAMBOO-PVC COMPOSITE

Pioneer offers photorealistic print technology for a remarkable natural look and a glass fiber-reinforced core for increased strength.

Apex PLUS



REINFORCED, CAPPED BAMBOO-PVC COMPOSITE

Apex PLUS offers you a resilient and natural looking composite with a glass fiber-reinforced core, that allows for increased strength and span capability.

Infinity



CAPPED BAMBOO COMPOSITE DECKING

Infinity leads the market in durability with a resilient polymer capping, and bamboo-plastic composite core.







RARE WOOD REPLICATED IN REINFORCED BAMBOO-PVC COMPOSITE

Pioneer redefines what composite decking is by capturing the soul and beauty of hardwoods in every grain and hue. Engineered with next-generation technology, it delivers the timeless look of natural timber for decades to come.

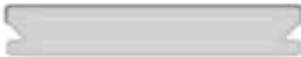
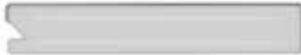
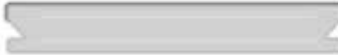

Pioneer

RANGE OF PROFILES

- Grooved board 1 x 6
(0.83" x 5.70" actual) 
- Starter board 1 x 6
(0.84" x 5.70" actual) 
- Wide grooved board 1 x 8
(0.83" x 7.48" actual) 
- Wide starter board 1 x 8
(0.84" x 7.48" actual) 
- Riser board 1/2 x 8
(0.55" x 7.24" actual) 
- Fascia board 1/2 x 10
(0.59" x 9.85" actual) 

SOLID PROFILE
SPAN 24" OC



RARE WOOD REPLICATED IN REINFORCED BAMBOO-PVC COMPOSITE

Composite comes in different shapes, styles, and qualities. Before purchasing a composite, familiarize yourself with your options in order to choose the best composite material for your job.



Decking



Cladding



Capping material:
Print surface finish with protective wear layer

Core material:
Bamboo foamed-PVC with glass fiber-reinforced core

GFR | GLASS FIBER REINFORCED

SOLID PROFILE
SPAN 24" OC

Luxurious rare wood design in an affordable bamboo composite

Pioneer composite charts new territory with its ideal blend of beauty and strength. Its advanced engineering elevates both its functionality and aesthetics to give you a board that is as natural looking as it is robust for the creative freedom your outdoor designs demand. Pioneer decking boards can be worked just like wood and can also be used to create stairs and cladding.

Apex PLUS



8110-2314-0500
Approved for use in the Wildland Urban Interface areas



REINFORCED, CAPPED BAMBOO-PVC COMPOSITE

Apex PLUS offers you a resilient and natural looking composite. Its bamboo foamed-PVC and glass fiber-reinforced core allows for increased span capability over Apex. Low-maintenance Apex PLUS is more stable with less expansion and contraction than its predecessor, and requires only basic cleaning for optimal longevity. Its protective cap is made from a resilient acrylic polymer coating, for long-term fade, scratch, and stain resistance. Apex PLUS also provides decay resistance against insects, moisture, and the elements. Apex PLUS is an eco-friendly alternative to timber that prevents deforestation and premature deck replacement and uses solar power within the manufacturing process.

REINFORCED, CAPPED BAMBOO-PVC COMPOSITE

Composite comes in different shapes, styles, and qualities. Before purchasing a composite, familiarize yourself with your options in order to choose the best composite material for your job.

Better performing, better looking composite

Apex PLUS offers you a resilient and natural looking eco-friendly composite, with a bamboo foamed-PVC and glass fiber-reinforced core, that allows for increased strength and span capability.



Capping material:
Engineered acrylic polymer

Core material:
Bamboo foamed-PVC composite with glass fiber-reinforcement



SOLID PROFILE
SPAN 24" OC
GFR | GLASS FIBER REINFORCED

Apex decking boards can be worked just like wood and can be used to create stairs, cladding, privacy screening, and more.



APEX PLUS COLOR GUIDE

The Apex and Apex PLUS dual color range adds an additional layer of color to each board to further enhance its natural look. The variance in shades within a single composite profile beautifully showcases the color tones found in timber making your composite all the more striking. Dual tone colors are ideal for mid-to-large-scale composite decks and projects or other areas that are all about that natural look.

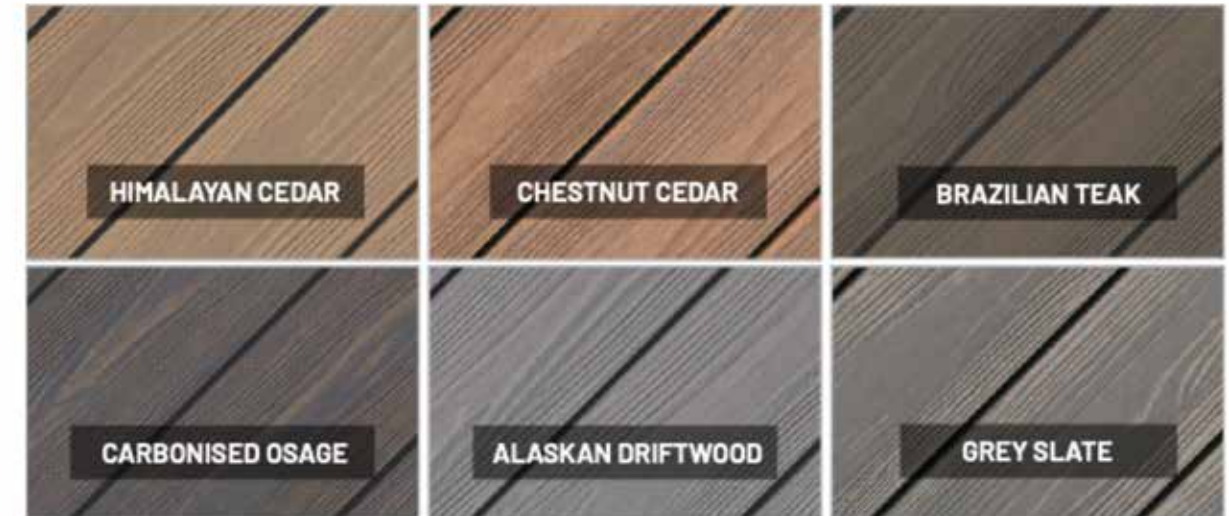

Apex PLUS

RANGE OF PROFILES

- Grooved board 1 x 6 (0.88" x 5.51" actual)
- Starter board 1 x 6 (0.90" x 5.51" actual)
- Square Edge board 1 x 6 **Special order only**
- Grooved board 1 x 8 (0.88" x 7.48" actual)
- Wide starter board 1 x 8 (0.90" x 7.48" actual)
- Riser board 1/2 x 8 (0.55" x 7.24" actual)
- Fascia board 1/2 x 12 (0.63" x 11.22" actual)

SOLID PROFILE
SPAN 24" OC



CAPPED BAMBOO COMPOSITE DECKING

Infinity bamboo composite is the ultimate in durability and one of the toughest co-extruded composite ranges available. Its resilient protective cap made of advanced polymer resists scratches, fade, mold, and mildew, and makes Infinity exceptionally low maintenance, requiring only the most basic cleaning for ultimate longevity. Enjoy the stain and slip resistance of this environmentally friendly alternative to wood.



Capping material:
Engineered polymer

Core material:
Bamboo PE composite



INFINITY COLOR GUIDE

Infinity composite offers exceptionally natural-looking colors thanks to its advanced color technology that gives each board unique color variation to embody the essence of timber. This specialized color streaking technique also ensures that no two boards are identical and that all boards boast the beautiful appearance of wood. Choose from a range of hues and tones to complement your space and style.



OASIS PALM



TIGER COVE









CONCRETE GREY

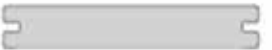

CARIBBEAN CORAL



RANGE OF PROFILES

- Grooved board 1 x 6
(0.91" x 5.35" actual) 
- Starter board 1 x 6
(0.92" x 5.35" actual) 
- Square Edge board 1 x 6 **Special Order Only** 
- Infinity IS grooved board 1 x 6
(0.91" x 5.35" actual) 
- Wide Infinity IS grooved board 1 x 7
(0.91" x 6.83" actual) 
- Riser board 1/2 x 8
(0.65" x 7.24" actual) 
- Fascia board 1/2 x 12
(0.71" x 11.90" actual) 

Square 4 Sides (S4S)

		Primed FJ Pine	Primed MDF	Raw MDF	Rad Pine C Select	#2 Spruce Eased Edge	C&BTR SYP	#2 SYP	Red Oak	White Oak	PVC
1x2	23/32"	16'									
	17MM		16'								
1x3	23/32"	16'									
	17MM		16'								
1x4	21/32"	81"/16'/17'									
	23/32"	16'/17'			8'-16'						
	3/4"				8'-16'	8'-16'	8'-16'	Random	Random		18'
	17MM		16'/17'								
1x6	21/32"	16'									
	23/32"	16'			8'-16'						
	3/4"				8'-16'	8'-16'	8'-16'	Random	Random		18'
	17MM		16'								
1x8	21/32"	16'									
	23/32"	16'			8'-16'						
	3/4"				8'-16'	8'-16'	8'-16'	Random	Random		18'
	17MM		16'								
1x10	21/32"	16'									
	23/32"	16'			8'-16'						
	3/4"				8'-16'	8'-16'		Random			18'
	17MM		16'								
1x12	21/32"	16'									
	23/32"	16'			8'-16'						
	3/4"				8'-16'	8'-16'		Random	Random		18'
	17MM		16'								
1x16	17MM		16'								
	5/4x4	1-1/8"	16'		12'/16'		12'/16'				18'
5/4x6	1-1/8"	16'			12'/16'		12'/16'				18'
	25MM		16'								
	5/4x8	1-1/8"	16'		12'/16'		12'/16'				18'

Pattern

		#2 Spruce TGV ECB	C&BTR Wrapped SYP TGV ECB	Primed FJ Pine TGV ECB	Primed FJ Pine REV Shiplap/VGroove	Primed MDF Shiplap	PVC REV Shiplap/ECB
1x6	3/4"	12'/16'	8'-16'				
	23/32"			16'			
	15MM					16'	
	5/8"				16'		
	1/2"						18'
1x8	1-1/8"	12'/16'			16'	16'	

Base	
CG 610	13
CG 616	13
CG 618	13
CG 620	13
CG 623	13
CG 713	12
CG 714	12
CG 810	12
CG 910	12

Base Cap	
CG 103	11
CG 106	11
CG 126	11
CG 127	11
CG 163	11
CG 164	11
CG 166	11
CG 254	11
CG 42	11

Cove	
CG 100	4
CG 33	4
CG 40	4
CG 50	4
CG 80	5
CG 81	5
CG 84	5
CG 85	5
CG 94	4

Crown	
CG 36	3
CG 37	3
CG 41	2
CG 45	2
CG 47	2
CG 49	2
CG 52	2
CG 75	3

Door WDW	
CG 180	6
CG 20	7
CG 280	6
CG 281	6
CG 327	7
CG 356	7
CG 366	7
CG 376	7
CG 442	7
CG 444	6
CG 445	6
CG 460	7
CG 470	7
CG RB3	6

MISC Trim	
CG 133	9
CG 135	9
CG 142	8
CG 183	9
CG 205	8
CG 206	8
CG 210	16
CG 233	16
CG 240	16
CG 266	8
CG 289	9
CG 300	9
CG 390	9
CG 394A	9
CG 397	9
CG 398	9
CG 425	9
CG 935	8
CG 937	8
CG 940	8
CG 941	8
CG 941A	8
CG 987	8
CG 988	8
CG 988A	8
CG 989	8

Door Comp	
CG 356	15
CG 376	15
CG 445	15
CG 4-9/16" Flat	15
CG 6-9/16" Flat	15
CG Split Jambs	15

Eased Edge	
CG 412E	17
CG 430	17
CG 432	17
CG 432512E	17
CG 432E	17
CG 452	17
CG 452E	17
CG 472	17

Window Stool	
CG 1020	14
CG 1021	14
CG 1021-7	14
CG 1162	14
CG 1164	14
CG 1195	14



833-641-1180

www.CharlesGrey.net

Winston Salem, NC